

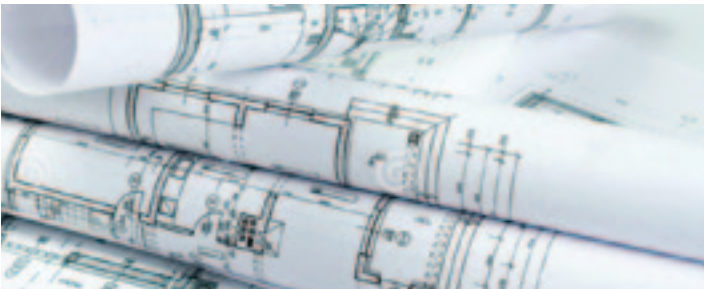

5200

ALUMINUM HOPPER WINDOW



800.475.5061 | gerkin.com

5200

ALUMINUM HOPPER WINDOW

DECADES OF PROVEN PERFORMANCE

The 5200 Rhino hopper window (projects in) is ideal for single or multi-story commercial projects. This window features a 2 3/8" thermally broken frame depth, reinforced power crimped sash corners and a sash that overlaps the frame allowing for one of the tightest windows on the market. These integrated features reduce heating and cooling loads on HVAC systems, provide long-term energy efficiency as well as utility savings to property owners.

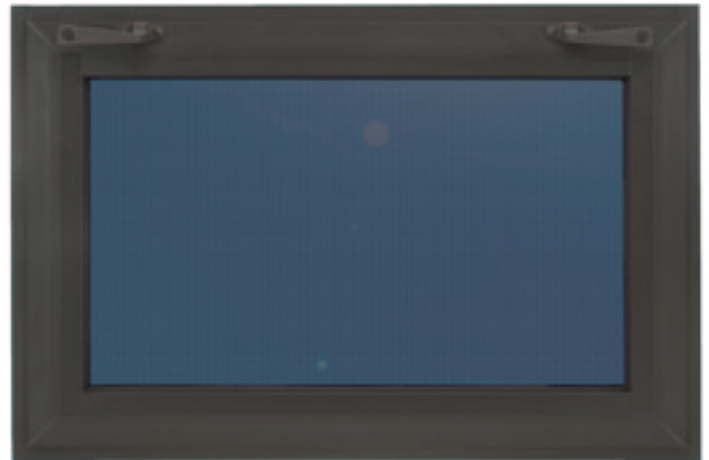

5200

ALUMINUM HOPPER WINDOW

5200 HOPPER | FEATURES

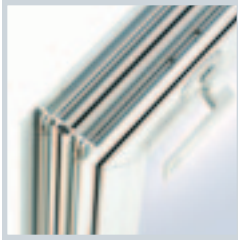

2 3/8" Thermally Broken Frame Depth:
We use a thermally broken frame and sash for improved thermal efficiency.



Sash Corners:
Gerkin uses reinforced power crimped sash corners. All sash corners are fortified with two engineered corner keys which are hydraulically crimped, creating a corner built to last for years of trouble free operation.



Sash Overlaps Frame:
Gerkin provides two compression seals on every sash and overlaps the frame of the window with one of the seals. This design allows Gerkin to have one of the tightest windows available.



Color Options:
White
Bronze
Clear Anodized
Dark Bronze Anodized



Cam Action Locks:
We use cam locks to compress the weather seals in the tightest manner possible. These locks also include a pole ring, which allows the window to open and close when located at a higher level in a building.

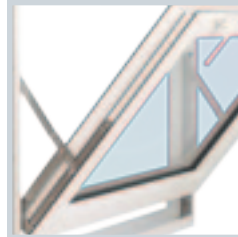

4-bar Friction Hinge:
Four bar friction hinges provide easy operation and tension adjustments.



Extruded Screen Frames:
The strength of extruded screen frames is a major maintenance cost advantage for Gerkin over easily damaged roll formed screens.

5200

ALUMINUM HOPPER WINDOW

5200 HOPPER | FEATURES

02030651

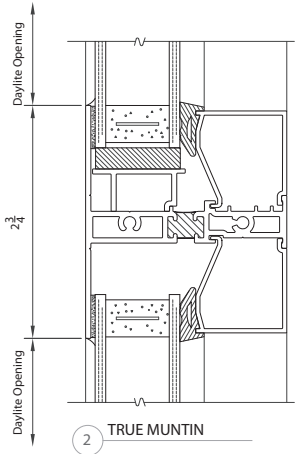
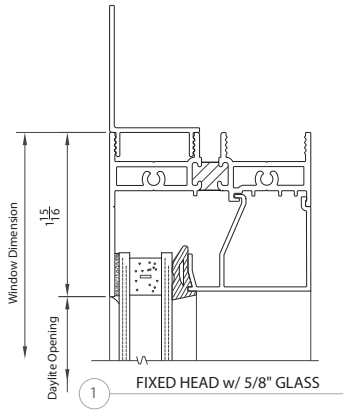

02030651

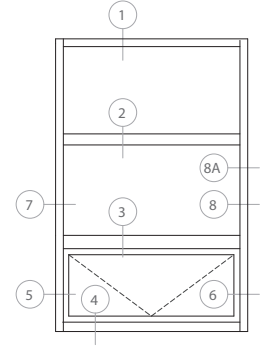
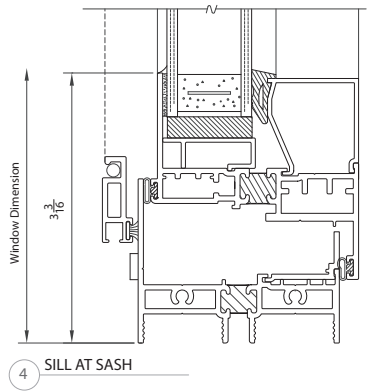
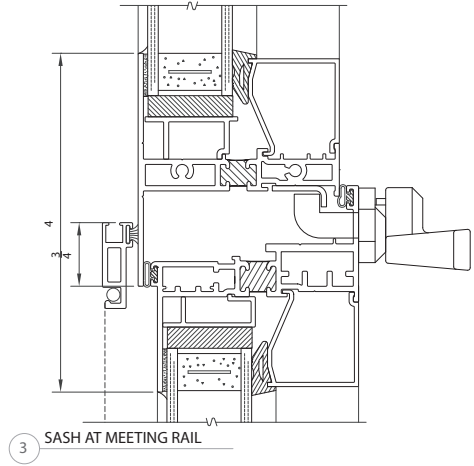

SHEET NO: 1

5200 SERIES INSWING HOPPER WINDOW

GERKIN WINDOWS & DOORS RESERVES THE RIGHT TO CHANGE OR DISCONTINUE MANUFACTURING ANY OF ITS STANDARD WINDOW SYSTEMS OR COMPONENTS WITHOUT PRIOR WRITTEN NOTICE.



5200

ALUMINUM HOPPER WINDOW

5200 HOPPER | FEATURES

SHEET NO:

2

5200 SERIES INSWING HOPPER WINDOW

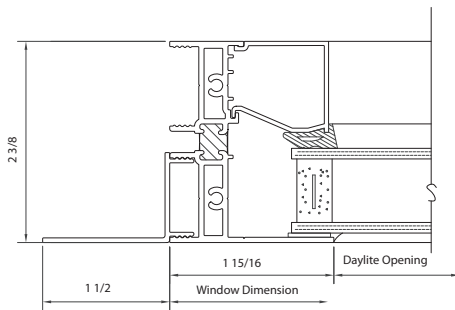

7 JAMB AT FIXED W/
OPTIONAL NAILING FLANGE

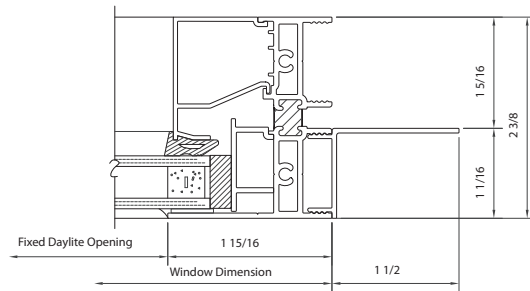

8 JAMB AT FIXED W/
5/8" GLAZING

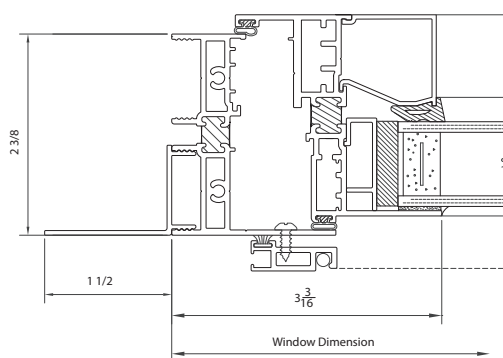

5 JAMB AT SASH W/
OPTIONAL NAILING FLANGE

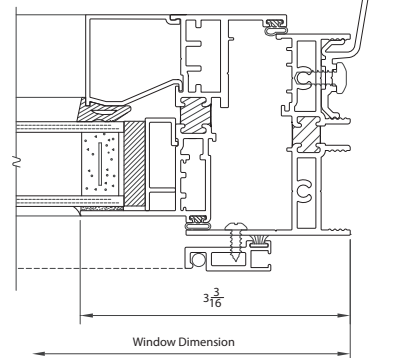

6 JAMB AT SASH W/
OPTIONAL STRAP ANCHOR



02/20/20

04/10/20

5200

ALUMINUM HOPPER WINDOW



5200 HOPPER | TEST RESULTS

NFRC | TEST RESULTS

U-Value w/LoE ³ /Argon	.48
Solar Heat Gain Coefficient	.20
Visible Transmittance	.42
Condensation Resistance	39
U-Value Air Only*	.51

AAMA | TEST RESULTS

Test Window | 49" x 72" Vert. 2-Lite

Class	CW-PG60-AP
Air Infiltration	.01 cfm/sq.ft.
Water	9.00 psf
Structural Wind Load	90.0 psf
Indoor/Outdoor Sound Transmission Class	28
Sound Transmission Class (w/ 1/4 LAM X 1/8 A)	36

AAMA | TEST RESULTS

Test Window | 61" x 68" Vert. 2-Lite

Class	CW-PG55-AP
Air Infiltration	.01 cfm/sq.ft.
Water	8.25 psf
Structural Wind Load	82.5 psf
Indoor/Outdoor Sound Transmission Class	28
Sound Transmission Class (w/ 1/4 LAM X 1/8 A)	36



*U-Values for our windows with 1/8" 366 LoE³ glass, air only, 1/8" clear glass, no muntins or argon in the air space.

Tested and Certified to AAMA/WDMA/CSA 101/I.S.2 A440-08
*U Values and CRF Values, tested with 1" insulating glass w/LoE³
U-Value/SHGC/VT/CRF Tested to NFRC 100/200/500



800.475.5061 | gerkin.com