



5800

ALUMINUM DOUBLE HUNG WINDOW



800.475.5061 | [gerkin.com](http://gerkin.com)

# 5800

## ALUMINUM DOUBLE HUNG WINDOW

### DECADES OF PROVEN PERFORMANCE

The 5800 Double Hung window has been tested to be used in sizes up to 60"x 99". The air infiltration rate is an amazing .03! This window features a 4 5/16" frame, block and tackle balances with an ultra-lift option, 1" insulated glass, and tilt sash operation. Both sashes operate and automatically lock into position when closed. Standard options include nail fins, subframe, panning and two anodized finishes.



# 5800

## ALUMINUM DOUBLE HUNG WINDOW

### 5800 DOUBLE HUNG | DETAILS

**Thermal Bar Break System:**

4 5/16" frame depth with a thermal bar break system is used to enhance the thermal values of the frame and sash.

**Frame & Sash Corners:**

All frame and sash corners use polyethylene gaskets for tighter air and water seals.

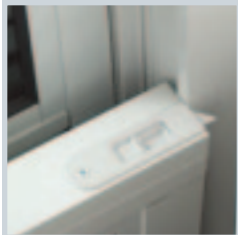
**Flush Mount Tilt Latches:**

We use attractive flush mount tilt latches, allowing both sashes to tilt in for easy cleaning and removal.

**Sill Locks:**

The lower sash uses an automatic latching system with the use of spring loaded sill locks. This eliminates the need for cam locks and offers instant security when the window is closed.

**Self-Latching Locks:**

Self-latching locks on the top sash at the head keep the top sash from dropping down while operating the lower sash. The top sash is fully functional and can be operated or tilted in for cleaning.

**Color Options:**

- White
- Clear Anodized
- Dark Bronze Anodized

**Sloped Sill:**

The double hung incorporates a sloped sill which eliminates the need for weeps under the sash. This allows for superior water drainage.

**Window Balances:**

The window balances are available in Class 1 or Class 5 options. Class 1 balances lift 30% of the sash weight while Class 5 lifts 70% of the sash weight.

**Balance Shoes:**

Balance shoes easily release the sash after tilting in to 90 degrees. This eliminates the need to raise one balance higher than the other, thus making removal easier.

**Sash Interlock:**

The upper and lower sashes interlock together which helps reduce deflection and creates a snug fit for a superior air infiltration rate.

**Weatherstripping:**

The double hung sash and frame have multiple weatherstrip locations uniquely positioned so that weatherstripping is never disconnected, which results in outstanding air infiltration performance.

# 5800

## ALUMINUM DOUBLE HUNG WINDOW

### 5800 DOUBLE HUNG | DETAILS

02/16/2015

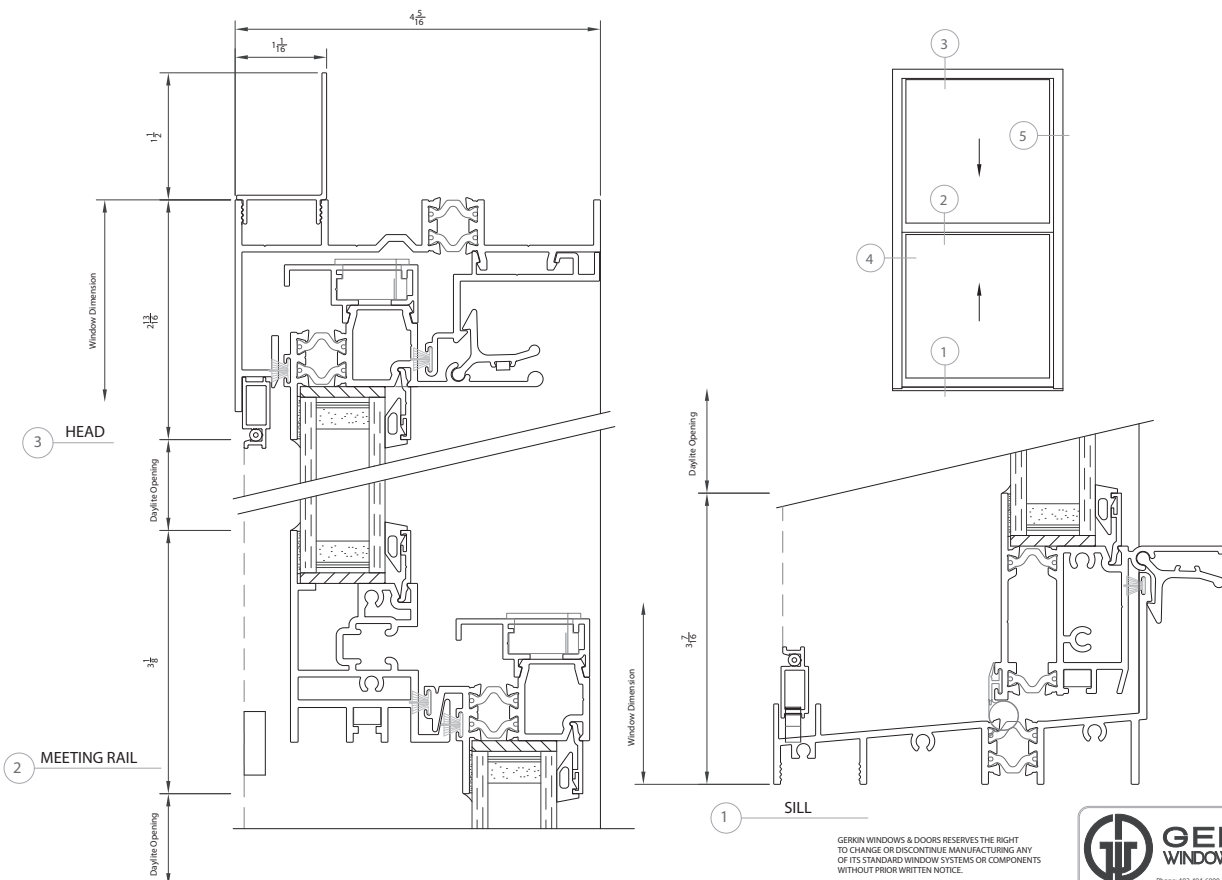

02/16/2015

SHEET NO: 1

5800 SERIES DOUBLE HUNG

GERKIN WINDOWS & DOORS RESERVES THE RIGHT TO CHANGE OR DISCONTINUE MANUFACTURING ANY OF ITS STANDARD WINDOW SYSTEMS OR COMPONENTS WITHOUT PRIOR WRITTEN NOTICE.



# 5800

## ALUMINUM DOUBLE HUNG WINDOW

### 5800 DOUBLE HUNG | DETAILS

SHEET NO:

2

5800 SERIES DOUBLE HUNG

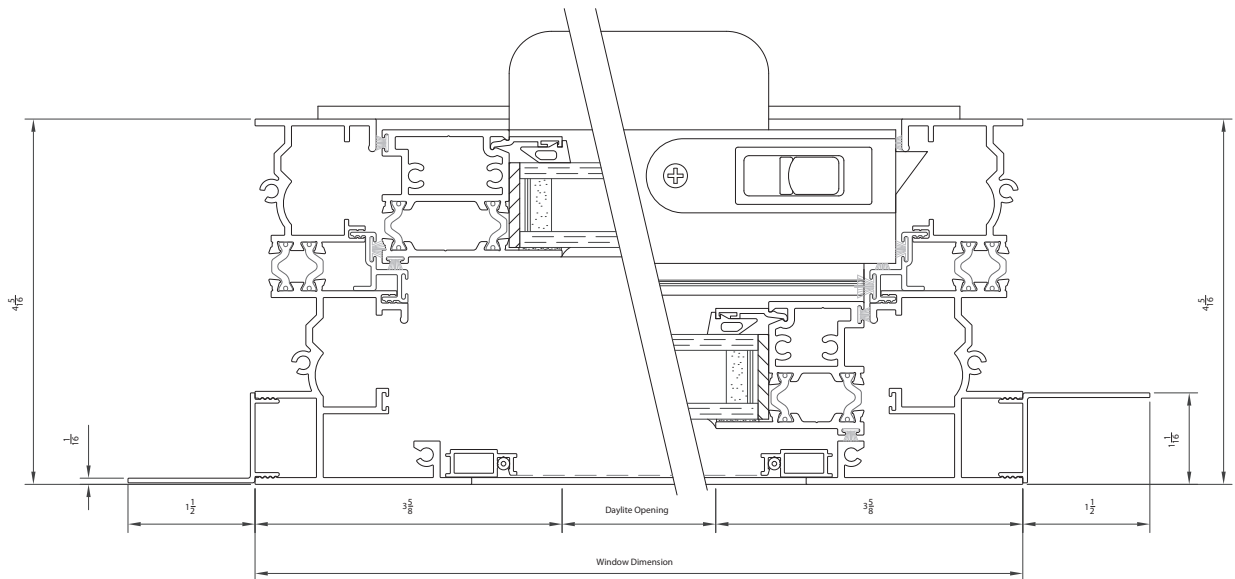

6 Jamb At Lower Sash W/ Flush Flange (Optional)

6 Jamb At Upper Sash W/ Flange



02/20/2022

06/10/2025 5:03 AM

# 5800

## ALUMINUM DOUBLE HUNG WINDOW



### 5800 DOUBLE HUNG | TEST RESULTS

NFRC   TEST RESULTS	
U-Value w/LoÉ³/Argon	.45
Solar Heat Gain Coefficient	.20
Visible Transmittance	.46
Condensation Resistance	43
U-Value Air Only*	.48

AAMA   TEST RESULTS	
<b>Test Window   60" x 99"</b>	
Class	LC-PG55-H
Air Infiltration	.03 cfm/sq.ft. @ 25 mph
Water	8.25 psf
Structural Wind Load	82.5 psf
Indoor/Outdoor Sound Transmission Class	N/A
Sound Transmission Class (w/ 1/4 LAM X 1/8 A)	N/A

AAMA   TEST RESULTS	
<b>Test Window   60" x 99"</b>	
Class	LC-PG55-H
Air Infiltration	.03 cfm/sq.ft. @ 25 mph
Water	8.25 psf
Structural Wind Load	82.5 psf
Indoor/Outdoor Sound Transmission Class	N/A
Sound Transmission Class (w/ 1/4 LAM X 1/8 A)	N/A

\*U-Values for our windows with 1/8" 366 LoÉ³ glass, air only, 1/8" clear glass, no muntins or argon in the air space.

Tested and Certified to AAMA/WDMA/CSA 101/ILS.2 A440-08

U-Value/SHGC/VT/CRF Tested to NFRC 100/200/500



800.475.5061 | gerkin.com